



PCU6.3-F



PCU6.1-F



PCU10.2.-F

User and Installation Manual

Unicook Airis Sense | Unicook Airis Sense Wi-Fi

Unicook

1. Introduction

Congratulations on buying the Unicook Airis Stove Guard.

This guide describes the use, installation and maintenance of:

- **Airis Sense** with Bluetooth
- **Airis Sense Wi-Fi** with Bluetooth and Wi-Fi

Before reading, please check the Unicook website for an updated version of this user manual.

1.1 Manufacturer Information

The product is designed and manufactured by Safera, a Finnish company of experts in smart and safe cooking.



1.2 Distributor

Unicook

Unicook Ltd

Unit 1, Villa Farm
Tunbridge Wells
Kent, TN3 9UN

Support product

Tél. : 0208 798 3462

Contents

1. Introduction
2. Information and Warnings
3. Stove Guard Description
4. Installation
5. Connecting the Safera App
6. Using the Stove Guard
7. Maintenance
8. Optional features
9. Troubleshooting
10. Technical Specifications
11. For private households in EU: Information on Disposal for Users of WEEE
12. Conformity
13. Firmware License Terms and Conditions

2. Information and Warnings

Follow these instructions carefully and pay particular attention to the instructions marked in the following way:

WARNING

Follow instructions marked with a warning accurately to prevent injury to persons and damage to property.

ATTENTION

Follow instructions marked with a note carefully to prevent damage to property.

HINT

Hints give you useful hints on using the appliance.

2.1 General Warnings

WARNING

This device is designed to the standard EN 50615 Category B - prevention of fires originating from overheating of oil in pans and pots on a hob. This device may not be suitable for fires originating from flammable materials left in proximity of the hob or on the hob. This device may not be suitable for fires originating from an oven.

Using Unicook Airis does not remove your responsibility for safe cooking. Read chapter 12 and 13 carefully for limitations.

Unicook Airis does not replace statutory home fire alarms. Ensure that fire safety at your home follows the local regulations.

Always take care when using the cooker and keep children and pets away.

Flame cooking is prohibited under the cooker hood.

Unicook Airis is meant for household use only. The appliance must not be used in professional kitchens or with cookers and hobs meant for professional use.

Unicook Airis is not user serviceable. For safety and reliability reasons, do not disassemble the product. Contact Unicook for all service needs.

Unicook Airis controls the stove and/ or oven only if it is equipped and correctly coupled with the power controlunit®.

All electrical connections must be

carried out by a qualified electrician.

If the connection cord is damaged, it must be replaced by the service personnel of the manufacturer or their representative to avoid hazards.

If the appliance was stored in a cold space, it must be allowed to warm up to room temperature before connecting it to mains power.

2.2 Battery Safety Information

WARNING

Failure to follow the instructions below may cause the batteries to leak fluid and gas, or even explode:

- Do not expose batteries to excessive heat, insert them with wrong polarity, or try to recharge them.
- Always replace all batteries at once, using the same make, model and age for all batteries.
- Do not leave empty batteries inside the device for prolonged periods.
- Recycle the empty batteries according to local regulations, do not place in domestic waste.
- If the leaked fluid gets into your eyes, do not rub them, as there is a risk of losing eyesight. Rinse your eyes with water and contact a physician immediately.
- If the leaked fluid gets into your mouth, rinse with water and contact a physician immediately.
- If the leaked fluid gets on your skin or clothes, rinse with copious

amounts of water to prevent burns.

3. Stove Guard Description

3.1 Purpose of Use

Unicook Airis is designed to improve the safety of domestic cooking. See compatibility in chapter 3.3. It is highly effective at preventing cooking fires.

Please note that the appliance is designed to prevent cooking fires. In case of a fire, you must follow appropriate procedures to prevent further damage. If necessary, call Emergency Services, explain the situation calmly and follow the instructions given to you.

3.2 Appliance Description

Unicook Airis can be mounted on the wall above the cooker. See adjacent figures.

- Ⓐ **Sensor unit**, mounted above the stove
- Ⓑ **Power control unit**, connected to the stove (various models available, see chapter 4.2)
- Ⓒ Power bracket with extra batteries

The Sensor unit Ⓐ and the power control unit Ⓑ are connected via a wireless connection.

3.3 Compatibility

Unicook Airis is compatible with most electrical cookers, hobs and ovens meant for household use:

- Traditional cast-iron cookers and hobs
- Ceramic cookers and hobs
- Induction cookers and hobs

- Cookers and hobs equipped with a timer, afterheat indicator, child proof lock or integrated switch-off system

Unicook Airis is compatible with cookers no wider than 90 cm. Also cookers with multiple fuels (eg. gas & electric) are not supported.



⚠ ATTENTION

For the most up to date mounting methods and stove compatibility, please refer to the “Installation Wizard” -section of the Safera App, see chapter 5.

Ⓐ Sensorunit

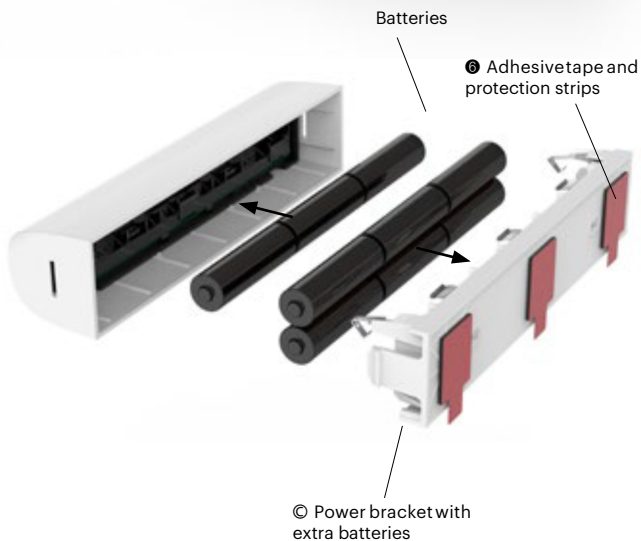
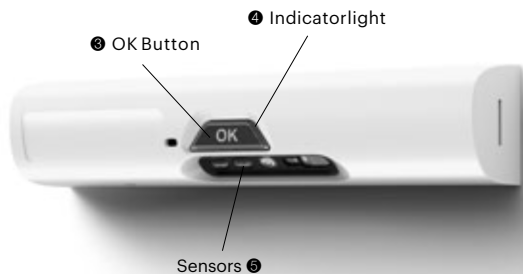

Here are the main steps of the installation:

Step 1/4

Prepare for the installation

Step 2/4

Install the power control unit ②

Step 3/4

Install the sensor unit ①

Step 4/4

Finish the installation (two options):

- Quick setup in default installation position
- Guided setup with the Safera App

4.1 Check the package content

Check the product and the contents of the package before installation:

- ① **Sensor unit**, mounted above the stove
 - ② **Power control unit**, connected to the stove (various models available, see chapter 4.2)
 - ③ Power bracket with extra batteries
- 9 x Batteries** for sensor unit (AA/LR6)

User and installation manual

WARNING

Please contact your vendor if you notice anything unusual about the appliance.

4.2 Install the power control unit ® according to the following instructions

PCU6.3-F

Fixed 3-phase connection.
See pages 8-9.



PCU6.1-F

Fixed 1-phase connection.
See pages 10-11.



PCU10.2.-F

2-phase connection with fixed
installation.
See pages 12-13.



▲ WARNING

If you are replacing the cooker or the power control unit ®, pair the power control unit again using the Safera App (see chapter 5).

PCU6.3-F - Installation

Fixed 3-phase connection.

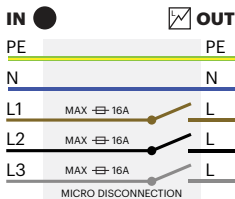
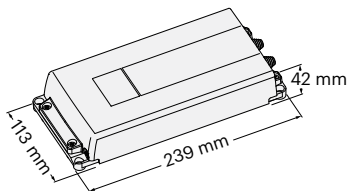
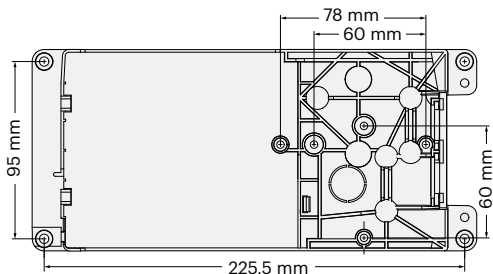

▲ WARNING

Turn the power off at the isolation switch and ensure that all rings, and if relevant the oven, is turned off.

OUT-wires are always energized when the power control unit® is connected to the mains power. If a wire is loose, it must be properly covered.

Do not install the power control unit® where it will be exposed to excessive heat: See operational ambient temperature on the power control unit.

⚠ ATTENTION

Install the power control unit® so that it is not exposed to moisture. Check that all cables can move freely.

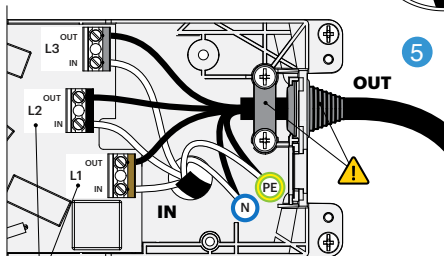
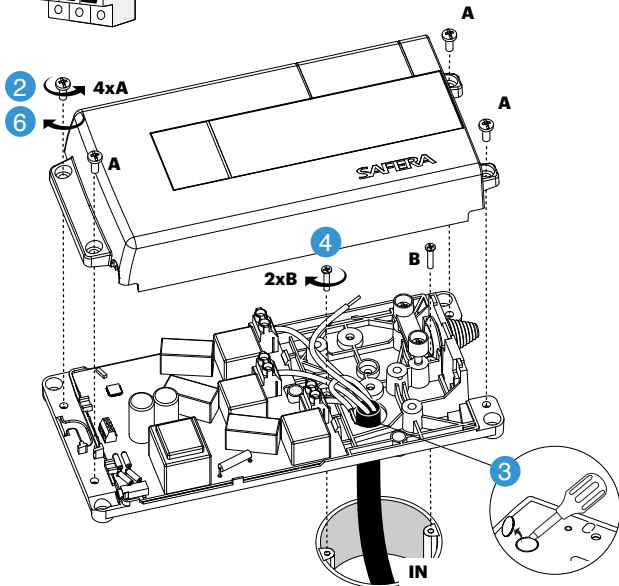
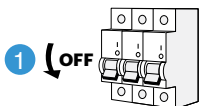

Phase order can be freely chosen. If only two phases are used, connect them to the terminals L1 and L2.

PCU6.1-F - Installation

Fixed 1-phase connection.

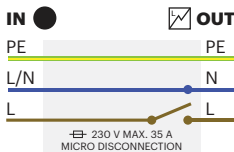
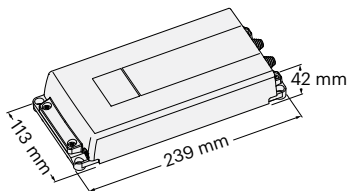
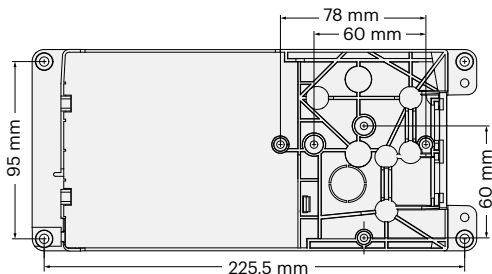

▲ WARNING

Turn the power off at the isolation switch and ensure that all rings, and if relevant the oven, is turned off.

OUT-wires are always energized when the power control unit® is connected to the mains power. If a wire is loose, it must be properly covered.

Do not install the power control unit® where it will be exposed to excessive heat: See operational ambient temperature on the power control unit.

⚠ ATTENTION

Install the power control unit® so that it is not exposed to moisture. Check that all cables can move freely.

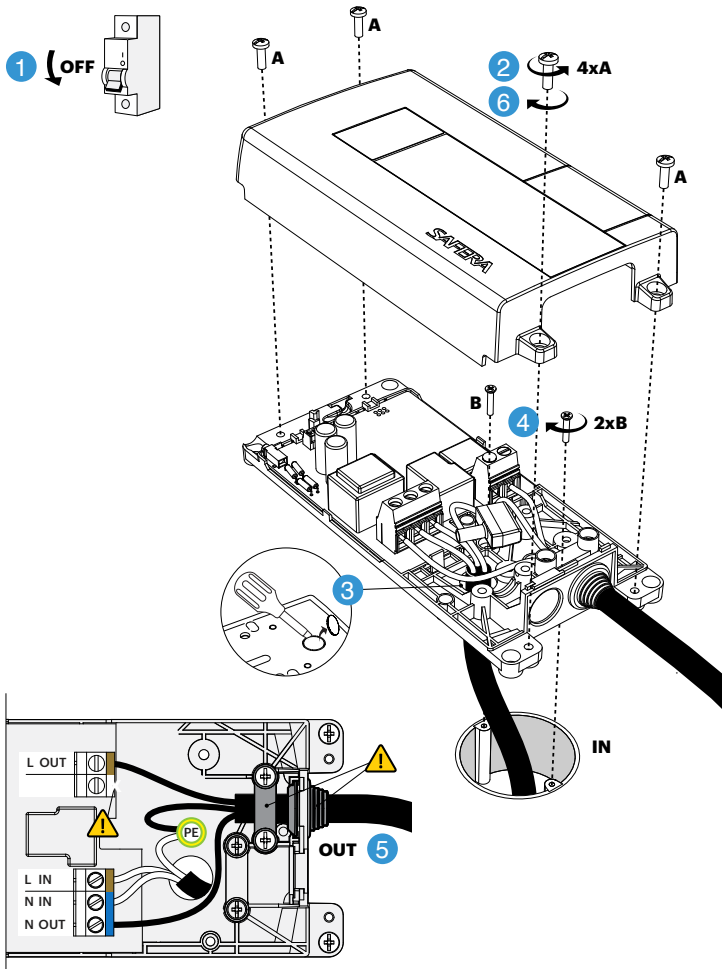

PCU10.2-F - Installation

2-phase connection with fixed installation.

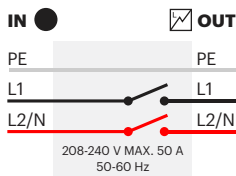
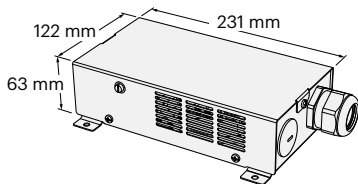
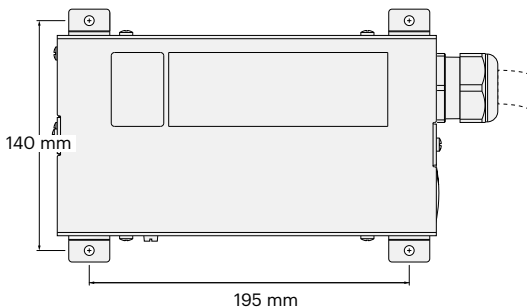

▲ WARNING

Turn the power off at the isolation switch and ensure that all rings, and if relevant the oven, is turned off.

The supply to the hob/cooker is always energised when the PCU is connected to the mains power.

Do not install the power control unit where it will be exposed to excessive heat: See operational ambient temperature for the power control unit ©.

The PCU can be installed behind an oven, below a hob, under a plinth or in a kitchen cupboard.

⚠ ATTENTION

The PCU must be installed in a position where it cannot become damp or wet.

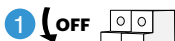

Take off fuses to the stove.

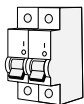

Remove the cover to access internal wiring.



Ground wire is connected to the cover.



Replace the cover.

6 Connect the plug (IN) to the wall socket.

3 Connect the OUT and IN cables to the screw terminals (cables not included).

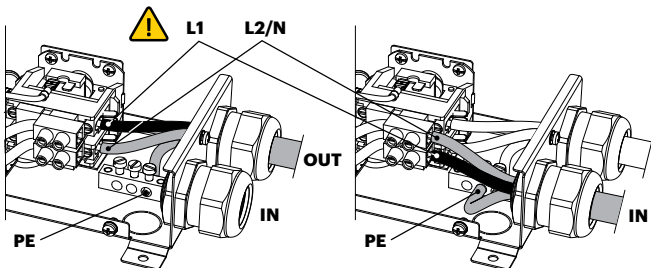

5 4xB

Mount the power control unit © on the wall behind the cooker or into the cabinet next to the cooker.

7 Connect the stove plug to the power control unit (OUT).

4.3 Install the batteries in the sensor unit ④ to activate the wireless connection to the power control unit ⑤

1. Open the sensor unit ④ by pushing one of the bracket's claws on the side gently with a flat headed screw driver and pulling off the sensor unit ④ from the bracket.



2. Place three batteries in the sensor unit ④ and six batteries in the power bracket ⑤. Notice the battery polarity marked on the sensor unit and on the bracket.

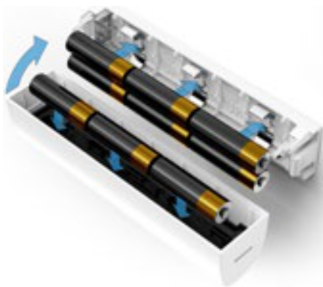

3. Place the sensor unit ④ over the power bracket ⑤ so that the cover snaps into place on both sides.
4. Switch on the power supply to the power control unit ⑥. The sensor unit ④ and the power control unit are now connected.

4.4 Mount the sensor unit ①

1. Remove grease and dirt from the surface before attaching the sensor unit ① with the adhesivetape ⑥.
2. Remove the protection strips from the adhesivetape ⑥.
3. Mount the sensor unit ① according to the table below and adjacent figures.

Installation	Height (H)
Wall mount, cooker width up to 60 cm	50 cm* ± 5 cm
Wall mount, cooker width from 60 cm to 90 cm	60 cm ± 5 cm

* **For Quick Installation** use the default position for electric cookers: no configuration is needed and you can finish the installation by checking the working order according to the chapter 4.6.

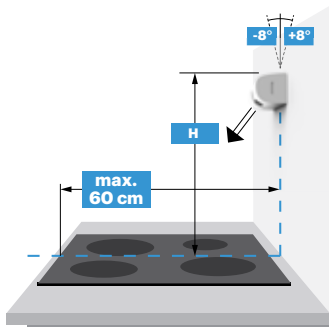

Sensors ⑤ field of view

▲ WARNING

Ensure the correct sensor direction: sensors ⑤ should look towards the cooker.

Make sure that there is no obstruction in the sensor's ⑤ field of view between the sensor unit ① and the stove.

The sensor unit ① should be mounted on the centerline of the cooker.

Make sure that the mounting location is free of direct sunlight and other sources of powerful light and heat.

4.5 Configure the sensor unit ①

You have two options to set up the sensor unit ① in your kitchen environment:

1. The sensor unit ① is installed in the default installation position

- Unicook Airis is pre-configured for default installation height of 50 cm on a wall above an electric cooker up to 60 cm wide.
- When default installation is used, no configuration is needed and you may finish the installation by checking the working order according to the chapter 4.6.

2. The sensor unit ① is installed in other than the default installation position or cooker type

- The sensor unit ① needs to be configured by using the Safera App (see chapter 5).

4.6 Check the working order

1. Turn on one plate with medium high power. With an induction cooker use a suitable pan.
2. Press and hold the OK button ③ for 5 seconds: the system should cut off the cooker power.
3. Test there is no power to the hob by attempting to switch on a ring. If ok, switch off the hob.
4. Return the cooker power by pressing the OK button ③: the indicator light ④ should flash green once. If not, see Troubleshooting in chapter 9.
5. Working order checked successfully:

Date Installer

5. Connecting the Safera App

With the Safera App you can easily set up the sensor unit ④ to fit your specific kitchen environment.

With the App you can also update the sensor unit ④ with the latest firmware (recommended) and use the advanced features of Unicook Airis (see chapter 6).

5.1 Connect the Safera App with Unicook Airis

1. Download and install Safera App to your mobile phone (search for "Safera App" in the App Store or Play Store).
2. Open the Safera App and choose "Connect to a New Device".
3. Press the OK button ③ on the sensor unit ④. The indicator light ④ starts flashing blue.
4. Choose "Safera" or "Safera Sense" which should appear on the list.
5. If asked for Bluetooth pairing, allow it. Android version will also ask for location permission, which is needed to use Bluetooth.

5.2 Update the sensor unit's ④ firmware

Check for firmware updates: open the main menu, choose "Firmware Update" and install the update if available.

ATTENTION

It's highly recommended to check for and install a firmware update if available during the installation.

5.3 Set up the sensor unit ④ with the Safera App

In the Safera App open the main menu and the "Installation Wizard".

The App will guide you through questions regarding your kitchen and cooker type and then set up the sensor unit ④ for your installation environment.





By completing the wizard you have successfully finished the installation and the stove guard is ready for use. Fill in the installation date and installer name to the chapter 4.6. in previous page.

6. Using the Stove Guard

6.1 Cooking Safety

Unicook Airis monitors the stove area and improves cooking safety by sounding an alarm and switching off the cooker power if it detects a potentially dangerous cooking situation. These situations may be, for example, an overheating pan or prolonged lack of human presence during cooking.

When you hear the alarm:

1. Check the situation calmly. If there is no danger, you can prevent the cooker power from being switched off by pressing the OK button  during the alarm and continuing to cook.
2. If you do not press the OK button  in 15 seconds, the stove guard will switch off the cooker and the oven: after switching off, a repetitive signal will sound and the indicator light  will flash red for 15 minutes.
3. When there is no more danger, you can return the power to the cooker and oven by pressing the OK button . First, turn the hob switches to the off position.
4. Ensure that the hazardous situation will not reoccur.

WARNING

Please note that not all possible hazards may be detected. Also note the limitations in chapters 12 and 13 .

6.2 Remote alarm

With Airis Sense Wi-Fi, you may activate the remote alarms by setting up a Wi-Fi connection via Safera App (see chapter 5.1 how to connect the Safera App) and creating a Safera Cloud account which allows you to set up the remote alarm settings.

6.3 Smart Cooking

By connecting the Safera App (iOS), you may use the smart cooking features which assist you in cooking with automated timers and temperature assistant. Install the Safera App according to the chapter 5.1.

6.4 Indicator light ④

LED color	Sound	Function
Red flashing fast	Yes, high pitch	Cooker danger
Red flashing once	Yes, low pitch 3-tone	Battery low
Blue flashing	No	Airis is looking for a Bluetooth connection to a mobile phone
Blue light, constant	No	Sensor unit ④ is in software update mode. Keep your mobile phone close and do not shut down the Safera App during software update.
Green light, constant	No	Sensor unit ④ is entering software update mode. If the green light does not turn blue in two minutes, remove and re-insert batteries.
Purple light, constant	No	Sensor unit ④ is in Optional Accessory Pairing Mode
Yellow light, constant	No	Factory reset in progress, may take a couple of minutes
Blue flash	Yes, medium pitch 3-tone	Water leakage alarm, see chapter 8.2.

7. Maintenance

7.1 Regular maintenance

To ensure continued safe and reliable operation, follow these maintenance instructions at least once every 12 months or more frequently if needed:

1. Press the OK button ③ to perform self-diagnostics: when the sensor unit ① is in working order, the indicator light ④ will flash in green. Any other color indicates a problem – please see chapter 9 Troubleshooting.
2. If there is visible dirt or grease in the sensor unit ①, wipe the sensor unit with a soft cloth moistened with water or a mild detergent, such as washing up liquid. Avoid pressing the appliance buttons and sensors ⑤.
3. It's highly recommended to always have the latest firmware version of the sensor unit ① installed, so check that your Safera App and the device firmware is up to date (see chapter 5.2).

7.2 Battery life and low battery

In normal use, the batteries should last between 2 to 3 years (Airis Sense) and 1 to 2 years (Airis Sense Wi-Fi). Frequent usage of the sensors and the Bluetooth connection with the smartphone app and a low quality wifi-connection will tend to decrease battery lifetime.

The sensor unit ① beeps and the indicator light ④ flashes red when the batteries are depleting (typically within 2 weeks of expiration). Replace the batteries according to the following instructions.

You may reset the low battery alarm for

12 hours by pressing the OK button ③.

If the batteries are not replaced, Unicook Airis switches itself off when the batteries are fully depleted. If the system is equipped with the power control unit ②, it will also shut down the electric power to the stove.

7.3 Battery replacement

1. Open the sensor unit ① by pushing the cover lock on the side gently with a flat headed screw driver and pulling off the sensor unit ① from the bracket.



2. Place three AA/LR6 Alkaline batteries in the sensor unit ① and six batteries in the power bracket ②. Notice the battery polarity marked on the sensor unit and on the bracket.

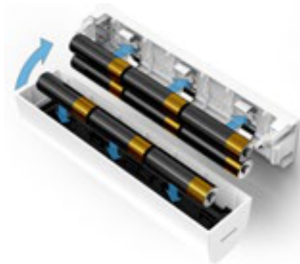

3. Place the sensor unit ① over the power bracket ② so that the cover locks snaps into their places on both sides.

8. Optional features

8.1 AUX-connection (optional)

Safera PCU6.3 and PCU6.1 power control units ® (with software version 6.2.21 or newer) are equipped with two auxiliary output signals AUX1 and AUX2 compatible with most automation and security systems. They can be used to send real-time status information of the stove guard.

8.1.1 Electrical specifications

- Optoisolated and potential-free AUX-outputs: no galvanic connection between the Airis system and the automation system.
- When the AUX outputs are active (ON), the optoisolator's output transistors will be held in conducting mode, thus enabling current flow from IN to OUT. This connection can be used exactly as a relay's contact, however the direction and amount of the current flow must be controlled as specified below. If necessary, the output states can also be inverted.
- Maximum IN-OUT voltage is 24 VDC.
- Maximum IN-OUT current is 10 mA.
- Only DC voltage between IN-OUT, no AC is permitted!

8.1.2 Coupling AUX-wire to the power control units PCU6.X

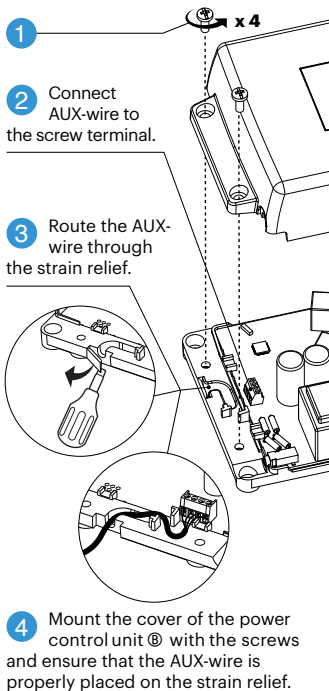

8.1.3 Example connection of one AUX-output

In this case the home automation system's logic input is pulled to ground potential when the AUX-output signal is active. Note that the maximum current pass in the optocoupler is 10 mA!

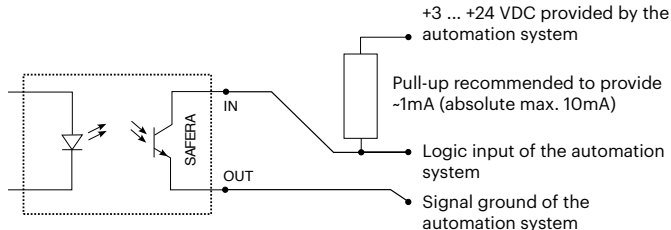

The diagram illustrates the connection of one AUX channel. AUX1 and AUX2 are similar.

① HINT





Most building automation systems are equipped with inputs that are designed in a way that they do not need the pull-up resistors. One example of this kind of input is a 2-terminal input designed for connecting between relay contacts (potential free connection). In this kind of situation the AUX can usually be wired directly to the automation system. The only thing that must be observed is the current flow direction (IN > OUT) and that the current passing through must be limited to less than 10 mA by the automation system.

8.1.4 AUX-signal logic interpretation

The AUX-signals can be interpreted in many ways:

- Simple ON/OFF information for any type of alarm (heat, fire or water leak). This can be read directly from AUX1 output.
- Simple ON/OFF information for cooking activity. This can be read directly from AUX2 output.
- Simple ON/OFF information for a fault condition. This can be read directly when both AUX1 and AUX2 are connected in series to the same line.
- Four-state output according to the table below. This can be used by reading both AUX1 and AUX2 separately into the automation system and using internal logic to decide the state.

8.1.5 OUTPUT signals in normal AUX-mode

AUX1 state	AUX2 state	Airis system status
OFF	OFF	Nothing to report No active cooking or dangerous situation detected.
OFF	ON	Normal cooking detected This state will activate immediately when the stove is powered. It will turn off in roughly 1 to 30 minutes after the cooking has stopped, depending on how hot or powerful the cooking has been. This delay serves two purposes: 1) the signal can be used for optimally controlling the cooker hood fan or a kitchen extractor fan 2) the signal OFF->ON steps can be used for counting the amount of cooking processes.
ON	OFF	Alarm Dangerous situation detected: cooking hazard, timeout or extreme stove temperature has caused a power cutoff from the cooker. Also, water leakage alarm will trigger this state. This state will be cleared only when the user presses the OK button  of the sensor unit  .
ON	ON	Service needed In most cases, power to the cooker has been cut off until the fault is resolved. This includes all critical sensor unit  or power control unit  faults. Press the OK button  of the sensor unit to see the exact cause for the fault.

8.1.6 Inversed AUX-mode

Inversed AUX-mode = all ON signals indicated as OFF and vice versa in the table above.







Inversed signal mode can be useful for example when the maximum reliability for fault detection is needed: if the wires are broken, or all electricity is cut off, the output will be the same in as the AUX1:OFF & AUX2:OFF "fault condition".

ATTENTION

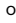
The inversed mode will create a larger load for the connected system, because both signals will be ON most of the time. For example, this may be harder for battery operated external clients. However, it will not affect the Airis system's own battery life.

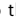
8.2 Water leakage sensor (optional)

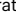
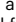
Unicook Airis can be equipped with a maximum of four Safera water leakage sensors. The sensors are placed in the typical leakage areas, e.g. under the dishwasher or sink.

- 1 Attach the sensors  in place.
- 2 Attach the plug  of the leakage sensor to the power control unit .
- 3 If there is an extra sensor, its plug  is connected to the connector  of the previous sensor.
- 4 Check the operation of the furthest sensor  by placing a damp paper towel against it for 15 seconds. When the water is detected, the sensor unit  gives a sound signal and indicator light  will flash in blue.
- 5 Reset the leakage alarm by pressing the OK button . Clean and dry the sensor.

HINT

If the sensor is left wet, the appliance will give another alarm 8 hours after signing off the previous one.

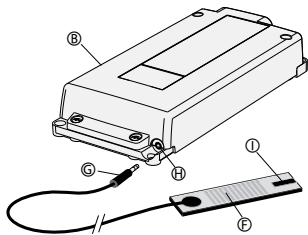
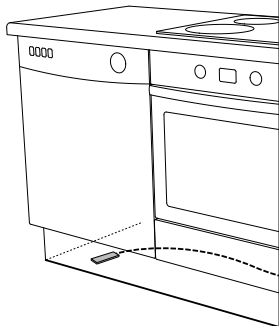

9. Troubleshooting

Press the OK button to find out the problem type. The indicator light ④:

Flashes in blue	Flashes in yellow
<p>Once: Problem with wireless connection between the sensor unit ① and the power control unit ②.</p> <p>Remedy: Manually pair the sensor unit with the power control unit with the Safera App, see chapter 5.</p>	<p>Once: Problem with sensors.</p>
<p>Twice: Problem with the power control unit ② .</p>	<p>Twice: Problem with sensor unit ① electronics or software.</p>
<p>Three times: power control unit ② over-heating or other malfunction.</p>	<p>Three times: Faulty installation position of the sensor unit ①: see remedy on the table below.</p>
<p>No flash or sound.</p> <p>Remedy: Replace the batteries, see chapter 7.3.</p>	

Problem	Remedy
Faulty installation position of the sensor unit ①.	<p>Sensor unit ① has detected that it is not installed on a level surface, pointing directly at the stove.</p> <p>If mounted under cooker hood, check that the cooker hood bottom surface is perfectly level.</p> <p>Also check that the sensor distance from the stove is within the limitations of chapter 4.4.</p>
The appliance repeatedly gives false alarms	<p>Test the working order according to chapter 4.6. If the product is in working order, but gives repeatedly false alarms, re-run the "Installation Wizard" in the Safera App to make sure that all kitchen and cooker related parameters are correct.</p>

10. Technical Specifications

Model name:

- Airis Sense Wi-Fi (IFU10B-WiFi)
- Airis Sense (IFU10B-BT)

Battery type: 9 x AA/LR6 Alkaline

Battery life (typical):

- Airis Sense: 2 to 3 years
- Airis Sense Wi-Fi: 1 to 2 years

Pollution degree: 2

Operational temperature:

- 0 ... 50 C (long-term)
- 0 ... 70 C (short-term)

Wireless connections:

Bluetooth 5.0 (BLE)

- Range: 10 ... 20 meters depending on construction materials present in the building
- Frequencies used: 2400...2483.5 MHz
- Maximum transmit power: 2 dBm
- Maximum radiated power: 3.5 dBm

802.11 b/g/n Wireless Communication (Airis Sense Wi-Fi only)

- Frequency range: 2400 MHz ... 2483.5 MHz
- Transmit power:
- 802.11 b: +20 dBm
- 802.11 g: +17 dBm
- 802.11 n: +14 dBm

Safera Wireless 2.0 (Proprietary protocol for power control units®)

- Range: 10 ... 20 meters depending on construction materials present in the building
- Frequencies used: 2400...2483.5 MHz
- Maximum transmit power: 2 dBm
- Maximum radiated power: 3.5 dBm

11. For private households in EU: Information on Disposal for Users of WEEE



This symbol on the product(s) and / or accompanying documents means that used electrical and electronic equipment (WEEE) should not be mixed with general household waste. For proper treatment, recovery and recycling, please take this product(s) to designated collection points where it will be accepted free of charge. Alternatively, in some countries, you may be able to return your products to your local retailer upon purchase of an equivalent new product.

Disposing of this product correctly will help save valuable resources and prevent any potential negative effects on human health and the environment, which could otherwise arise from inappropriate waste handling. Please contact your local authority for further details of your nearest designated collection point. Penalties may be applicable for incorrect disposal of this waste, in accordance with your national legislation.

12. Conformity

Safera Oy declares that Airis is in compliance with the following EU directives and standards. Full text of the EU declaration of conformity is available at the following internet address: www.safera.com/support/doc/sense

Directives: 2014/53/EU, 2015/863/EU, 2011/65/EU, 2012/19/EU

Safera Oy declares that Airis is in compliance with the following UK legislation. Full text of the UKCA declaration of conformity is available at the following internet address: www.safera.com/support/doc/sense

UK Legislation: The Electrical Equipment (Safety) Regulations 2016, SI 2016 No. 1101. The Radio Equipment Regulations 2017, 2017 SI No. 1206. Electromagnetic Compatibility Regulations 2016, SI 2016 No. 1091. The Restriction of the Use of Certain Hazardous Substances in Electrical and Electronic Equipment Regulations 2012, SI 2012 No. 3032. The Ecodesign for Energy-Related Products and Energy Information (Amendment) (EU Exit) Regulations 2019, SI 2019 No. 539.

Stove guard performance, only for electric hobs, only when used in conjunction with the power control unit
®: EN 50615:2015(Category B)

Safety EN 60730-1:2011, IEC/EN 60335-1:2020, ed 6.0, IEC/EN 60335-2-31:2018, ed 5.2, IEC/EN 62368-1:2014 + C:2015 + A11:2017

Radio & EMC EN 300 328 V2.2.2, EN 301 489-1 V2.2.0, EN 301 489-17 V3.2.0, EN 62311:2008

RoHS EN 50581:2012



Mikko Reinikainen, CEO, Safera Oy
Espoo Finland 20.11.2020

13. Firmware License Terms and Conditions

IMPORTANT NOTICE: THIS IS A SMART COOKING ASSISTANCE PRODUCT. THIS IS NOT A SAFETY PRODUCT AND IS NOT INTENDED TO PREVENT ACCIDENTS. YOU EXPLICITLY AGREE AND UNDERSTAND THAT THE PRODUCT, THE SAFERA APPLICATION (MOBILE APPLICATION) AND/OR A COMPATIBLE POWER CONTROL UNIT ARE NOT EMERGENCY ALARM OR RESPONSE SYSTEMS AND WILL NOT NOTIFY, CONTACT OR DISPATCH ANY EMERGENCY AUTHORITIES. ANY AND ALL EMERGENCY SITUATIONS SHOULD BE DIRECTED AT THE RELEVANT EMERGENCY AUTHORITIES.

ABSENT YOU HAVING THE SAFERA APPLICATION INSTALLED TO AN UP-TO-DATE SMARTPHONE (iOS OR ANDROID) AND HAVING PROPERLY INSTALLED A DULY COMPATIBLE POWER CONTROL UNIT, THE FUNCTIONALITY OF THIS PRODUCT WILL BE LIMITED - PLEASE SEE www.safera.com/products FOR FURTHER DETAILS.

FURTHER, THE USE OF THIS PRODUCT IN ACCORDANCE WITH THE CENELEC STANDARD EN 50615:2015 REQUIRES, ADDITIONALLY, THE PROPER INSTALLATION OF A DULY COMPATIBLE POWER CONTROL UNIT, PLEASE SEE

WWW.SAFERA.COM/PRODUCTS FOR FURTHER DETAILS.

PLEASE READ SAFERA'S PRIVACY POLICY AT www.safera.com/privacypolicy. FOR CLARITY, IN ORDER TO IMPROVE ITS PRODUCTS AND SERVICES AND THE FUNCTIONALITY OF THE APPLICATION, SAFERA USES THE SENSORS (INCLUDING, AMONG OTHERS, A MICROPHONE) WITHIN THE PRODUCT TO COLLECT GENERAL COOKING RELATED DATA, IN THE PROCESS OF WHICH SAFERA MAY COLLECT DATA WHICH CAN BE CONSIDERED AS PERSONAL DATA IN CERTAIN COUNTRIES.

BY USING THE PRODUCT, YOU EXPLICITLY UNDERSTAND AND AGREE TO THE AFORESAID.

These are the Unicook Airis Firmware License Terms and Conditions ("Terms") between you ("You") and Safera Oy ("Safera"). Please read these Terms carefully before commencing the use of the Product.

BY USING THE PRODUCT, YOU AGREE TO BE BOUND BY THESE TERMS. YOU MAY NOT USE THE PRODUCT WITHOUT AGREEING TO THE TERMS.

13.1 Disclaimer of Warranty

Safera's distributor, from whom you have acquired the Unicook Airis ("Product") or who otherwise distributes the Product ("Distributor") may grant You a warranty for the Product in accordance with the Distributor's warranty terms.

YOUR USE OF THE PRODUCT AND/OR THE SAFERA APPLICATION AND/OR A COMPATIBLE POWER CONTROL UNIT IS AT YOUR SOLE DISCRETION, RESPONSIBILITY, LIABILITY AND

RISK. THE PRODUCT AND/OR THE SAFERA APPLICATION AND/OR A COMPATIBLE POWER CONTROL UNIT DO NOT DIMINISH OR REMOVE YOUR RESPONSIBILITY TO FOLLOW APPLICABLE AUTHORITIES' RULES, REGULATIONS AND ORDERS OR RESPONSIBILITY TO ACT WITH DUE CARE TO AVOID DAMAGE TO PROPERTY AND PERSONS.

SAFERA HEREBY DISCLAIMS ALL WARRANTIES AND CONDITIONS IN RELATION TO THE PRODUCT TO THE MAXIMUM EXTENT ALLOWED BY APPLICABLE LAW, WHETHER STATUTORY, EXPRESS OR IMPLIED, INCLUDING, BUT NOT LIMITED TO, WARRANTIES OF TITLE, MERCHANTABILITY, FITNESS FOR A PARTICULAR PURPOSE, ACCURACY, AND NON-INFRINGEMENT OF THIRD PARTY RIGHTS. TO THE EXTENT YOU AND THE DISTRIBUTOR HAVE NOT AGREED OTHERWISE IN WRITTEN FORM, THE DISTRIBUTOR DISCLAIMS THE SAME MATTERS.

13.2 Limitation of Liability

EVEN IF YOU USE THE PRODUCT, YOU MUST DULY CONSIDER USE OF OTHER EQUIPMENT AND MEASURES TO AVOID DAMAGES, AND YOU WILL BE RESPONSIBLE FOR MAINTAINING IN FORCE THE INSURANCES FOR PROPERTY AND PERSONS. SAFERA OR THE DISTRIBUTOR WILL NOT BE LIABLE FOR ANY DAMAGE TO PROPERTY OR PERSONS OR FOR ANY MONETARY OR FINANCIAL DAMAGES CAUSED BY THE FUNCTIONING OR NON-FUNCTIONING OF THE PRODUCT AND/OR THE SAFERA APPLICATION AND/OR A COMPATIBLE POWER CONTROL UNIT, WHETHER DIRECT OR INDIRECT, SPECIAL,

PUNITIVE OR CONSEQUENTIAL, TO THE MAXIMUM EXTENT ALLOWED UNDER THE APPLICABLE LAW.

TO THE MAXIMUM EXTENT ALLOWED UNDER THE APPLICABLE LAW:

- (a) YOU OR ANY THIRD PARTY MAY NOT MAKE CLAIMS TOWARDS SAFERA BASED ON DEFECTS IN THE PRODUCTS OR OTHERWISE RELATED TO THE PRODUCTS; AND
- (b) IF SAFERA WOULD BE LIABLE NOTWITHSTANDING THE DISCLAIMERS IN THESE TERMS, SAFERA'S LIABILITY, INCLUDING ANY REFUNDS AND REMUNERATION, IS LIMITED TO THE PRODUCT'S PURCHASE PRICE, AND SAFERA IS NOT LIABLE FOR INDIRECT, SPECIAL, PUNITIVE OR CONSEQUENTIAL DAMAGES; AND
- (c) TO THE EXTENT YOU AND THE DISTRIBUTOR HAVE NOT AGREED OTHERWISE IN WRITTEN FORM, THE DISTRIBUTOR'S LIABILITY, INCLUDING ANY REFUNDS AND REMUNERATION, IS LIMITED TO THE PRODUCT'S PURCHASE PRICE, AND THE DISTRIBUTOR IS NOT LIABLE FOR INDIRECT, SPECIAL, PUNITIVE OR CONSEQUENTIAL DAMAGES.

13.3 Firmware License

The firmware included and/or embedded in the Product may be used only as integrated in the Products when using the Product for its intended and designed use. The firmware may not be extracted or otherwise separated from the Product, or used separately from the Product or used in connection with the use of other products or as part of other products. The firmware

may not be (a) copied or otherwise reproduced (possible reinstallation shall be performed by Safera or a repair shop authorized by Safera), (b) modified, disassembled, decompiled or reverse engineered or (c) delivered to third parties other than as part of the Product when assigning the Product's ownership. You are granted only the right to use the firmware in accordance with this provision. Copyright and other intellectual property rights in and to the firmware (and to any and all other software in the Products) are owned solely by Safera.

13.4 Governing Law and Dispute Resolution

These Terms shall be construed in accordance with the laws of Finland excluding its choice of law provisions and the UN Convention on Contracts for the International Sale of Goods.

Any dispute, controversy or claim arising out of or relating to these Terms, or the breach, termination or validity thereof, shall be finally settled by arbitration in accordance with the Rules for Expedited Arbitration of the Finland Chamber of Commerce, in English language in Helsinki, Finland.

To the maximum extent allowed under applicable law, You explicitly waive your right to participate in any class actions, class arbitrations or other similar grouping of parties.

Notwithstanding the above, Safera shall be entitled to seek equitable and/or injunctive relief or take legal actions concerning overdue payments in any court of law having jurisdiction over Your or Safera's domicile. For clarity, this Section does not limit your rights under

the applicable law of your domicile.

You and the Distributor are free to agree on terms regarding governing law and dispute resolution applicable between You and the Distributor and on other terms applicable between You and the Distributor. Safera is not bound by any such terms or any other terms of the Distributor.

13.5 General

If any provision of these Terms is held to be contrary to law, such provision shall be changed and interpreted so as to best accomplish the objectives of the original provision to the fullest extent allowed by law. Other provisions will remain in full force and effect.

All notices regarding these Terms must be made in writing. You may contact Safera at: support@safera.com.

These Terms constitute the complete and exclusive agreement between You and Safera with respect to the subject matter hereof and supersedes all prior proposals, understandings, marketing materials and other communications with respect to the subject matter of these Terms.

Excluding Safera, no one may amend, extend or otherwise modify these Terms.

The headings of the Sections of these Terms are informative in nature and shall not be used in the interpretation thereof.

